



Applications

- Parking lot
- Wall Pack
- Roadway
- Billboard

Certification

- UL
- DLC

Description

Easy Replace & Install
High Luminous Efficacy 125 lm/W
Wireless Lighting Control

Specifications

Model Name	WP050	
Power Consumption	50W	
Correlated Color Temperature	5000K (4000K available)	
Luminous Flux *	6,250 lm	
Luminous Efficacy *	125 lm/W	
Color Rendering Index	80 Ra	
Light Distribution	Asymmetric Wide	
BUG Rating	B1 – UX – G1	
LED Chip Manufacturer	SAMSUNG	
Input Voltage	100 - 277 Vac	
Input Current	Max 0.6A (@100Vac)	
Power Factor	≥0.9 at Max load	
Frequency	50 / 60 Hz	
Driver Type	Constant Current (CC)	
Driver Manufacturer	KMW INC. / Made in Korea	
Size (W x L x H)	15.4 x 9.5 x 4.4 (inch)	390.0 x 242.0 x 110.5 (mm)
Weight (Driver included)	7.1 lb	3.2 Kg
Material	Body	Cast Aluminum
	Optic	Silver Coating Reflector
	Cover	Tempered Glass 3.2T (Clear)
Finish	Powder Coating	
IP Rating	IP66	
Mounting Option	Wall Mount, Swivel Bracket, Pole Mount	
Operating Temperature	-22°F ~ 140°F	-30°C ~ 60°C
Life Time	LED Module	100,000 Hours (L70@77°F / 25°C)
	Driver	50,000 Hours (@77°F / 25°C)
Warranty	5 Years	
Option		
Control System	Wireless (ZigBee) / Sensor (Daylight)	
Surge Protection	Line-Line 20KV, Line-FG 20KV	

*Tolerance : ± 5%

Photometry

See photometric .ies files for details.

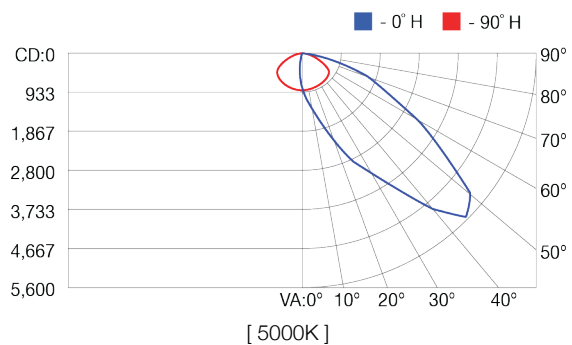
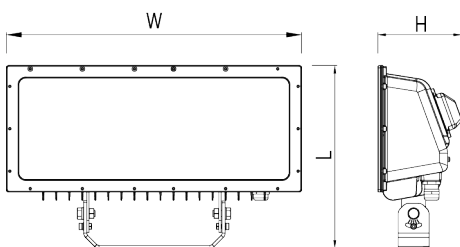

Control Specification (Optional)

ZigBee		Wireless Control
Standard	2.4 GHz – IEEE 802.15.4 (Compatible)	
Network	Mesh	
RF Tx Power	Max. +8 dBm (Typ. 6 dBm)	
Data Rate	250 kbps	
Security	128 bit AES Encryption Algorithms	
Dimmer	PWM, 0 – 10 Vdc	
Antenna	Omni Type, 2 dBi	
Input Voltage	15 Vdc	
Max. Power Consumption	0.3 W (@15Vdc)	
Daylight Sensor		Smart sensor Module
Operating Voltage Range	5 – 50 Vdc (TYP. 24 Vdc)	
Max. Power Consumption	0.6 W (@15Vdc)	
Operating Temperature Range	-22°F ~ 122°F / -30°C ~ 50°C	
Detectable Illumination Range	9.2 – 92 fc (Default : 64 fc) / 100 – 1,000 lx (Default : 700 lx)	
LED Light Bi-level Setting	0 % to 30 % (Adjustable) / 10% (Default)	
Output Signal	PWM	
Weight (G.W.)	0.33 lb / 150 g	

Ordering Information

WAPA : Area Flood Lighting (Order Code Usage : WP050-A50WMNG1S)

	000	-	O	OO	OO	O	OO	O
	Power consumption		Input voltage	CCT(K)	Installation Type	Dimming control & Sensor	Fixture Color	Surge Protector
WP	050=50W 075=75W 100=100W		A=100~277V B=100~240V	30=3000 40=4000 50=5000	WM=Wall Mount MB=Mount Bracket PH=Pole Mount Horizontal PV=Pole Mount Vertical	N=None D=Daylight Sensor Z=ZigBee	G1=Gray Powder	S=Yes Black=No