



Applications

- Parking lot
- Wall Pack
- Roadway
- Billboard

Certification

- CE
- VDE
- UL
- FCC
- DLC
- PSE
- TIS
- KC

Description

Easy Replace & Install
High Luminous Efficacy 125 lm/W
Wireless Lighting Control

Specifications

Model Name	WP050		
Power Consumption	50W		
Light source	0.2W Mid Power LED Chips (Qty : 192 pcs)		
Correlated Color Temperature	5000K (3500K / 4000K / 6500K available)		
Luminous Flux *	6,250 lm		
Luminous Efficacy *	125 lm/W		
LED Driving Current *	83.3 mA		
Color Rendering Index	80 Ra		
Light Distribution	Asymmetric Wide		
BUG Rating	B1 – UX – G1 (Backlight – Uplight – Glare)		
LED Chip Manufacturer	SAMSUNG		
Input Voltage	100 ~ 277 Vac		
Input Current	Max 0.6A (@100Vac)		
Power Factor	≥0.9 at Max load		
Frequency	50 / 60 Hz		
Driver Type	Constant Current (CC)		
Fixture & Driver Manufacturer	KMW INC. / Made in Korea		
Size (W x L x H)	15.4 x 9.5 x 4.4 (inch)	390 x 242 x 110.5 (mm)	
Weight (Driver included)	7.1 lb	3.2 Kg	
Material	Body	Cast Aluminum	
	Optic	Silver Coating Reflector	
	Cover	Tempered Glass 3.2T (Clear)	
Finish	Powder Coating		
IP Rating	IK Rating	IP66	IK07
Mounting Option	Wall Mount, Mount Bracket, Pole Mount		
Operating Temperature	-22°F ~ 140°F	-30°C ~ 60°C	
Life Time	50,000 Hours (@77°F / 25°C)		
Warranty	5 Years (12 hours usage per day)		
Option			
Control System	Wireless (ZigBee) / Sensor (Daylight)		
Surge Protection	Line-Line 20KV, Line-FG 20KV		

*Tolerance : ± 5%

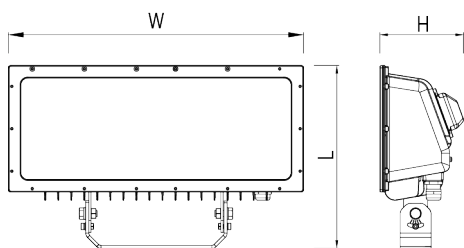

Mount Bracket Type

Photometry

See photometric .ies files for details.

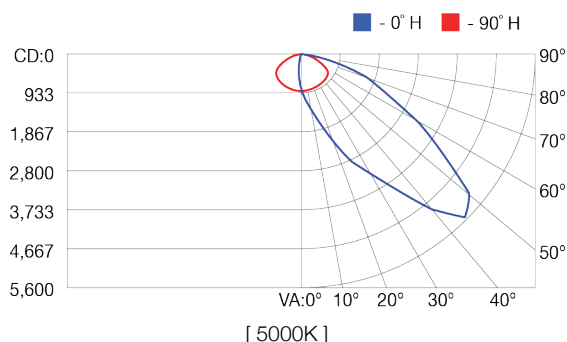

Control Specification (Optional)

ZigBee		Wireless Control
Input Voltage	15 Vdc	
Max. Power Consumption	0.3 W (@15Vdc)	
Standard	2.4 GHz - IEEE 802.15.4 (Compatible)	
Network	Mesh	
RF Tx Power	Max. +8 dBm (Typ. 5 dBm)	
Data Rate	250 kbps	
Security	128 bit AES Encryption Algorithms	
Dimmer	PWM, 0 – 10 Vdc	
Antenna	Omni Type, 2 dBi	
Daylight Sensor		
Operating Voltage Range	5 Vdc (MAX. 6 Vdc)	
Max. Power Consumption	40 mW (@5Vdc)	
Detectable Illumination Range	9.2 – 92 fc (Default : 64 fc) / 100 – 1,000 lx (Default : 700 lx)	
Output Signal	DC level	

Ordering Information

Order Code Usage : WP050-A50MBNG1S

WP	000	-	0	00	00	0	00	0
	Power Consumption		Input Voltage	CCT (K)	Installation Type	Control System	Fixture Color	Surge Protector
	050=50W 075=75W 100=100W		A=100~277V B=100~240V	35=3500K 40=4000K 50=5000K	MB=Mount Bracket PH=Pole Mount Horizontal MBJ=Mount Bracket with J box/	A=Daylight Sensor Z=ZigBee N=None	G1=Gray Powder	S=Yes N=None